

Operating instructions

Solar Sign & Safetylight Profi 2,5/500



Customer support:

If you have problems or questions regarding this product, simply contact us!

By phone: +49 9605-92206-0

By e-mail for ordering spare parts: ersatzteil@esotec.de

By e-mail for questions about the product: technik@esotec.de

Product: Manufacturer Item No.: 102270

These instructions relate **ONLY** to this product and contain important information for using the product for the first time. Please keep these instructions for later reference and should always accompany the product in the event of transference to a new user.

1. Introduction

Dear Customer,

Thank you for purchasing the solar light.

With this solar light you purchased a product manufactured according to the current state of technology.



This product fulfils all requirements of the valid European and national regulations. The conformity was proved. The relevant declarations and documentation are deposited with the manufacturer.

To maintain this state and guarantee a safe operation, you as the user will have to follow this operating manual!

2. Safety Instructions



- In case of damages caused by not following this operating manual, the warranty rights will expire! We exclude liability for any consequential damages!
- We exclude liability for property or personal damages caused by inappropriate handling or not following the safety instructions.
- In these cases any guarantee rights will expire.

Due to safety and admission reasons (CE) it is not allowed to arbitrarily reconstruct and/or change the solar light.

Therefore, please keep to the operating manual. The accident prevention rules of the association of the industrial trade cooperative association for electric plants and working material are to be considered in industrial environments

3. Intended use and function

The solar light is designed for year-round outdoor use and can be used as a sign or emergency light. It must be mounted on a shadow-free wall.

The built-in battery is charged by the solar module in the upper part of the luminaire. The solar module is inclinable and can therefore be ideally adapted to seasonal solar radiation.

Depending on the application, the luminaire can operate in 2 operating modes. Warm and cold white LEDs are installed as light sources.

During longer periods without solar radiation, the battery is insufficiently charged to ensure constant operational readiness. However, this does not mean that the solar light is defective. Wait for the next sunny days, the lamp will function accordingly again.

During the winter months, the luminaire can continue to be operated outdoors. Only the solar module must be kept free of snow.

4. Installation and commissioning

1. Remove the lamp carefully from its packaging.
2. Now mount the lamp on a house wall. Use the supplied mounting material!

Note: Please note that the final mounting position is not in the middle of the luminaire. This is offset by approx. 1 cm!

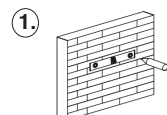

Drill 2 holes at a distance of 9.5 cm into the wall.

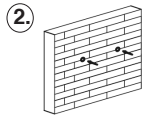

Insert the two plugs into the holes.

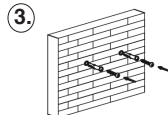

Screw the two screws into the dowels. Keep some distance (approx. 8 mm) to the wall.

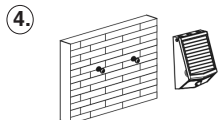

Now place the lamp on the screws and move the lamp to the right until the screws are fixed in the back plate.

3. The luminaire can be operated in 2 different modes. These can be selected via the switch below the solar module.

Press 1st = Mode A: The LEDs light up permanently in darkness with approx. 50% of the maximum luminosity. The PIR sensor is not active! After 5 hours or battery capacity less than 30%, mode B is automatically activated.

Press 2nd = Mode B: The PIR sensor is activated! In darkness a warm white LED lights up. When a movement is detected by the PIR sensor (120°/ 2-6 m), the warm white light is switched off and the bright white LED light is switched on. The light then changes again after approx. 20 seconds without movement.

Press 3rd = switched off

Note: When changing the operating mode, the light flashes briefly to confirm the change!

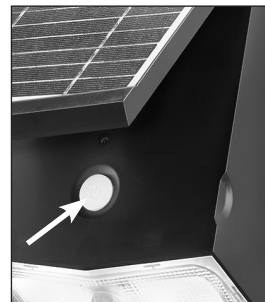

4. Loosen the two screws on the upper side of the solar module and adjust the angle of the solar module according to your requirements. Then tighten the two screws again.

The solar light is now activated and ready for use!



5. Changing the battery pack

1. Turn the light off.
2. Unscrew all screws on the back of the lamp (Fig. 7) and remove the cover plate.
3. Remove the battery pack and disconnect the plug (Fig. 8).
4. Insert an identical battery pack and reconnect the plug connection.
Note: The plug is protected against reverse polarity. Please do not use force.
5. Ensure that the seal (Fig. 8) is correctly seated around the battery compartment and press the back plate firmly back onto the lamp.
6. Tighten all screws with a suitable screwdriver.
7. Mount the lamp and select the desired mode.

Note: Used batteries or accumulators must be disposed of in an environmentally friendly manner and should not be disposed of with household waste. Your dealer is legally obliged to take back the old batteries.

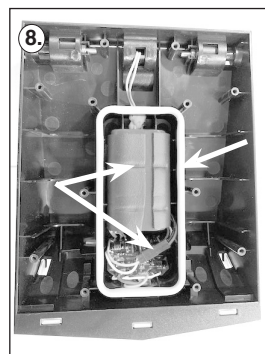
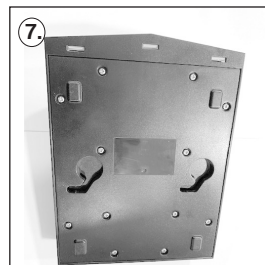

7. Malfunctions

Lamp does not switch on in darkness

- An second light source (e.g. street lamp) simulates daylight on the solar module and prevents the luminaire from switching on. Place the luminaire in a darker place!
- Battery depleted? Replace the battery!

8. Technical data

- Solar panel: Monocrystalline 2.4 Wp
- PIR sensor: 120°, range 2 - 6 m
- Mounting height: Max. 4 m
- Illuminant: 6 pcs. warm white (3000 K)
30 pcs. cold white (6000 K)
- Luminous intensity: Max. 500 lm (cold white)
- Battery: Li-Ion 3.7 V/ 3000 mAh
- Protection class: IP 65
- Protection class: III
- Temperature range: -20°C to +45°C

Manufacturer/Importer:

esotec GmbH - Gewerbegebiet Weberschlag 9 - D-92729 Weiherhammer
Tel.-Nr: +49 9605-92206-0 - Fax.-Nr: +49 9605-92206-10
Internet: www.esotec.de

Disposal:

Dear customer,
please cooperate in avoiding waste. When you intend to dispose of the product in future, please consider that it contains valuable raw materials suited for recycling.

Therefore, do not dispose it of with domestic waste but bring it to a collection point for the recycling of waste electrical and electronic equipment. Thank you very much for your cooperation!



Copyright, esotec GmbH

Rechargeable battery notes

- Rechargeable batteries should not be played with by children. Never leave rechargeable batteries lying around; they could be swallowed by children or pets.
- Rechargeable batteries must never be short-circuited, disassembled or thrown into fire. This leads to a danger of explosion!
- Leaking or damaged rechargeable batteries can cause chemical burns when they come into contact with skin. For this reason, please make use of suitable protective gloves.
- Rechargeable batteries should only be replaced by structurally identical rechargeable batteries from the same manufacturer. Normal batteries must not be used since these are not rechargeable.
- Make sure the rechargeable batteries are inserted with the correct polarity.
- For long periods of time of non-use (for example, storage), remove the inserted rechargeable batteries to avoid damages via the leaking rechargeable batteries.

Battery Recycling:

- Used batteries or accumulators must be disposed in the domestic waste.
- The consumer is legally obliged to bring back old accumulators upon usage, e.g. to public waste collecting locations or to the place (shops, etc.) where those batteries are sold.
- Batteries that contain harmful substances are marked with the "strike through dustbin" and one of the chemical symbols.

