

Usage instructions

LED PIR Solarlight

“Sunnylight DUO Color“



These instructions relate **ONLY** to this product and contain important information for using the product for the first time. Please keep these instructions for later reference and should always accompany the product in the event of transference to a new user.

1. Introduction

Dear Customer,

Thank you for purchasing the solar light.

With this solar light you purchased a product manufactured according to the current state of technology.

CE This product fulfils all requirements of the valid European and national regulations. The conformity was proved. The relevant declarations and documentation are deposited with the manufacturer.

To maintain this state and guarantee a safe operation, you as the user will have to follow this operating manual!

2. Safety Instructions



- In case of damages caused by not following this operating manual, the warranty rights will expire! We exclude liability for any consequential damages!
- We exclude liability for property or personal damages caused by inappropriate handling or not following the safety instructions.
- In these cases any guarantee rights will expire.

Due to safety and admission reasons (CE) it is not allowed to arbitrarily reconstruct and/or change the solar light.

Therefore, please keep to the operating manual.

The accident prevention rules of the association of the industrial trade cooperative association for electric plants and working material are to be considered in industrial environments

3. Usage in Accordance with Requirements

The solar light is constructed for the outdoor usage and operation. The integrated batteries are charged by the solar cell in the upper part of the light.

The powerful „Nichia“ light-emitting diode will be switched-on at darkness and upon detection of a motion (thermal change) in the detection range of the PIR switch. The LED will shine for approx. 50 seconds after the detection of the last motion. The lighting color can be selected with a switch between cold white and warm white.

-- However, please note that the duration of illumination may decrease due to a lack of sunshine as well as in the winter months--

In case of longer periods without sunshine (insolation) the batteries are charged only insufficiently and is thus not able to guarantee a permanent readiness for operation. However, this does not indicate that the solar light is defect. Please wait for the next sunny days and the light will again be working accordingly

4. Initiation

1. Please carefully take all parts out of the package.
2. Please carefully connect the earth rod with the bar and insert it into the ground.
Note: Please do not use force.
3. Unscrew the lamp head from the luminary anticlockwise (pic. 1) and remove the strip from the battery case (pic. 2). With the switch you can select the lighting color between cold white and warm white (pic. 3).
4. Now reassemble the illuminant with the upper part and carefully plug the upper part of the lamp into adapter on the pole.

The solar light is now activated.

Note: In order to avoid scratching the wall carrier, do not use sharp-edged tools when tightening the nuts.

Note: The duration of illumination is strongly dependent on the intensity and duration of sunshine during the day. During the winter months the duration of illumination will generally be shorter. If the lamp should not irradiate on the first evening, please wait for a sunny day.

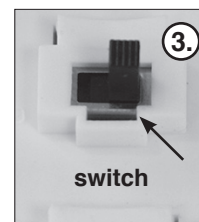
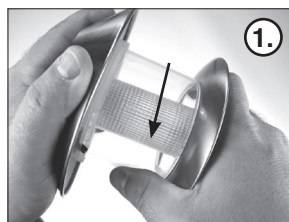

5. Exchange of batteries

1. Hold the upper part and screw off the lower part of the lamp head clockwise and take apart the parts (pic. 4).
2. Unscrew the reflector also clockwise and remove it (pic. 5).
3. Take the used batteries out of the battery compartment and insert two new batteries, according to polarity, into the battery compartment. It is recommended to charge the new batteries in a battery charger before inserting them (pic. 6).
4. Re-assemble the lamp in reverse order.

Note: Used batteries or accumulators must be disposed of in a non-polluting way and do not belong into the domestic waste. Your dealer is legally obliged to take back and recycle old batteries.

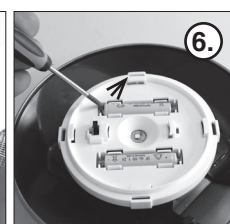
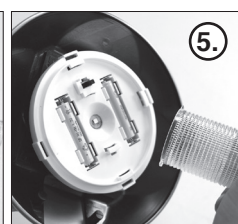
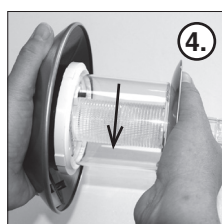

6. Malfunctions

- **Lamp is not automatically switched on at darkness**
 - An outside light source (e.g. streetlight) simulates daylight and prevents the lamp from switching on. Place the lamp at a darker location.
- **Lamp is not switched on at darkness or only for a short period of time.**
 - Is the lamp connected?
 - Batteries weak or defective. Exchange of the batteries.

7. Technical Data

Solar module:	0,4 Wp crystal silicon
Set of accumulators:	2 x NiMh 1.2 V/900 mAh (AAA-size)
Detection range motion detector:	90°/ 6m
Light emitting diode:	2 „Nichia“ light emitting diode (LED)
Luminous color:	2800 K (warmwhite) or 6500 K (coldwhite)
Luminosity:	14 lm
Duration of illumination:	max. 8 hours in case of fully charged set of accumulators

Customer support:

If you have problems or questions regarding this product, simply contact us!

Monday to Friday 9 am to 12 noon and 1 pm to 4 pm.

By phone: +499605-92206-0

By e-mail for ordering spare parts: ersatzteil@esotec.de

By e-mail for questions about the product: technik@esotec.de

Product: Manufacturer Item No.: 102092

Battery take-back

- Batteries must not be discarded into domestic waste.
- The consumer is legally required to return batteries after use, e.g. to public collecting centers or to battery distributors.
- Contaminant-containing batteries are labeled with the sign “crossed-out trashcan” and one of the chemical symbols. Used batteries should be disposed environmentally friendly and should not be discarded into domestic waste. Your dealer is legally required to take back old batteries.

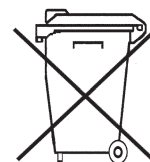

NiMh

Rechargeable battery notes

- Rechargeable batteries should not be played with by children. Never leave rechargeable batteries lying around; they could be swallowed by children or pets.
- Rechargeable batteries must never be short-circuited, disassembled or thrown into fire. This leads to a danger of explosion!
- Leaking or damaged rechargeable batteries can cause chemical burns when they come into contact with skin. For this reason, please make use of suitable protective gloves.
- Rechargeable batteries should only be replaced by structurally identical rechargeable batteries from the same manufacturer. Normal batteries must not be used since these are not rechargeable.
- Make sure the rechargeable batteries are inserted with the correct polarity.
- For long periods of time of non-use (for example, storage), remove the inserted rechargeable batteries to avoid damages via the leaking rechargeable batteries.

Manufacturer / Importer**esotec GmbH**

Gewerbegebiet Weberschlag 9 - D-92729 Weiherhammer
Tel.-Nr: +49 9605-92206-0 - Fax.-Nr: +49 9605-92206-10
Internet: www.esotec.de

Disposal:

Dear customer,

please cooperate in avoiding waste. When you intend to dispose of the product in future, please consider that it contains valuable raw materials suited for recycling.

Therefore, do not dispose it of with domestic waste but bring it to a collection point for the recycling of waste electrical and electronic equipment.

Thank you very much for your cooperation!

