

# Operating manual waterpump "Fountain 160 LED"



## Customer support:

If you have problems or questions regarding this product, simply contact us!  
**Monday to Friday 9 am to 12 noon and 1 pm to 4 pm.**  
By phone: +49 9605-92206-0  
By e-mail for ordering spare parts: [ersatzteil@esotec.de](mailto:ersatzteil@esotec.de)  
By e-mail for questions about the product: [technik@esotec.de](mailto:technik@esotec.de)  
**Product: Manufacturer Item No. pump: 101988**

## 1. Introduction

Dear Customer, thank you for purchasing the solar pump kit.  
With this solar pump kit you purchased a product manufactured according to the current state of technology.



**This product fulfils all requirements of the valid European and national regulations. The conformity was proved. The relevant declarations and documentation are deposited with the manufacturer.**

To maintain this state and guarantee a safe operation, you as the user will have to follow this operating manual!

## 2. Safety Instructions



- In case of damages caused by not following this operating manual, the warranty rights will expire! We exclude liability for any consequential damages!
- We exclude liability for property or personal damages caused by inappropriate handling or not following the safety instructions.
- In these cases any guarantee rights will expire.

Due to safety and admission reasons (CE) it is not allowed to arbitrarily reconstruct and/or change the solar pump kit.

Therefore, please keep to the operating manual.

The accident prevention rules of the association of the industrial trade cooperative association for electric plants and working material are to be considered in industrial environments

## 3. Intended use

This submersible pump is designed for pumping water in garden ponds, fountains, water dishes, etc. It can pump water through a hose connection or can be operated through attached lifting tubes with water sprinklers.

A solar module, battery box or a power pack with a voltage of 6 to 9 volts can be used as the energy source. When used with a solar module, the pump works only if enough solar radiation strikes the solar module.

The delivery rate of the pump can be adjusted using the regulator on the front side of the pump. The water pump has no On/Off switch. As soon as the pump is connected to its power supply, it starts pumping water.

## 4.1 Installation and commissioning without LED ring

1. Roll out the connecting cable of the pump completely.
2. Place the pump in water.
3. Connect the lifting tubes till they project out of the water surface. For this, first attach the reducer to the pump.
4. You can now choose from 3 different water nozzles or a single jet nozzle. The multiple jet nozzle attachments are always snapped onto the nozzle cup.
5. Alternatively, the pump can also be used for pumping water through a hose. For this, you just have to attach a hose to the pump's pipe.
6. Now supply power to the water pump through a solar module or battery box.

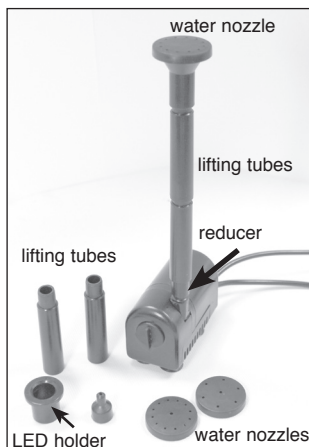

**Note:** The plug has reverse-polarity protection, no force should be used while inserting. The glass of the solar module is fragile.  
Caution! Risk of injury! A broken module cannot be repaired again and must be disposed off in an environmental-friendly way.

7. If the pumping capacity is too high, you can reduce the amount of water. Simply turn the regulator on the front side of the pump in clockwise direction. Please do not use force while adjusting. The adjustment range is 45°.

## 4.2 Operation with LED light ring

The solar pump can power a LED light ring. This light ring can be easily slipped onto the lifting tube.

Electrical connection is established via the socket on the pump. For this, remove the drain plug, insert the light ring plug in the socket and tighten the cap nut firmly. Depending on the model, the lighting is activated via a twilight sensor.

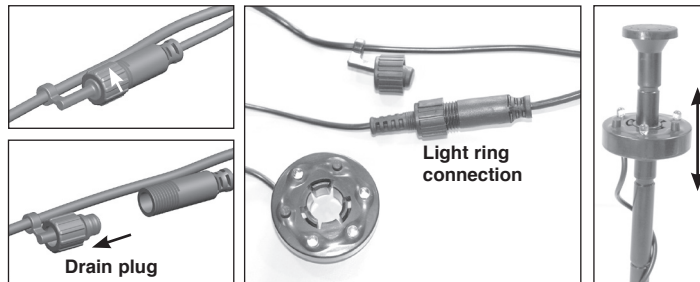

## 5. Service and maintenance

To ensure the performance of the pump, the pump must be washed out with warm water from time to time, depending on the rate of water contamination. For this, open the filter encasement:

**Note:** Please do not use unnecessary force to assemble or disassemble the pump. The parts are very delicate and can easily be broken.

1. Pull up the pump's connector.
2. Carefully pull the front lid of the pump off, pulling like a sled forwards (Illustration 1).
3. Turn the front lid of the pump app. 45° counterclockwise (Illustrations 2 and 3) and carefully pull the lid forwards (Illustration 4). Please take care in observing the plastic starter switch.
4. Pull the impeller wheel carefully from the pump with the starter switch (Illustration 5).
5. Now clean all of the parts carefully with warm water.
6. Then place the starter with the impeller wheel carefully into the hole of the front lid (Illustration 6).
7. Now carefully slide the lid back axle into the pump. Make sure the lid is on correctly and that the opening is completely sealed by it.
8. Now turn the front lid again back into the initial position.
9. Now push the lower part of the pump completely together onto the pump encasement.

**The pump is once again ready for operation.**

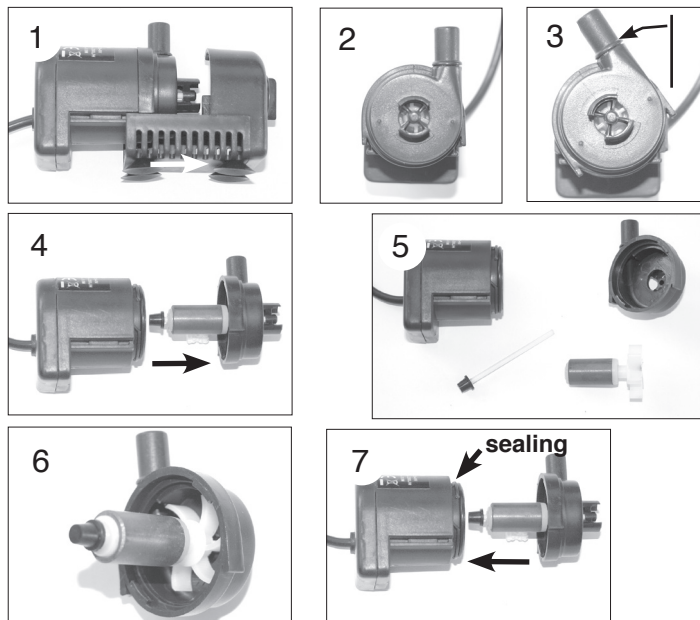

## 6. Malfunction

### Pump is not pumping water

- Is the pump completely submerged in water?
- Is the pump dirty? Cleaning the pump, see Point 6.

## 7. Technical data

- |                           |              |
|---------------------------|--------------|
| • Operating voltage:      | 6 - 9 V DC   |
| • Power consumption (6V): | app. 1 W     |
| • Pump lift (6V):         | max. 0,5 m   |
| • Delivery rate:          | max. 160 l/h |
| • Degree of protection:   | IP 68        |
| • Grade of protection:    | III          |
| • Operating temp. range:  | +4 to +40°C  |
| • Dry run protection:     | No           |

## 8. Spare parts

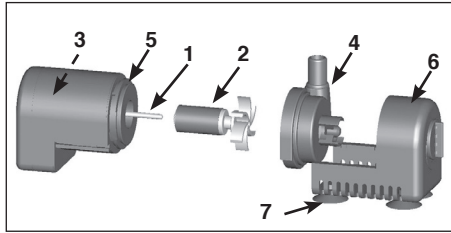

- |  |                  |
|--|------------------|
| 1. White ceramic shaft:                  | Item No.: 911010 |
| 2. Pump impeller:                        | Item No.: 911011 |
| 3. Internal rubber bush:                 | Item No.: 911012 |
| 4. Front cover:                          | Item No.: 911013 |
| 5. Seal for cover:                       | Item No.: 911014 |
| 6. Sliding carriages with suction bases: | Item No.: 911015 |
| 7. Suction bases (4 pieces)              | Item No.: 911016 |
| 8. Complete nozzle set:                  | Item No.: 911017 |

## Manufacturer/Importer

**esotec GmbH** - Gewerbegebiet Weberschlag 9 - D-92729 Weiherhammer  
Tel.-Nr: +49 9605-92206-0 - Fax.-Nr: +49 9605-92206-10  
Internet: [www.esotec.de](http://www.esotec.de)

## Disposal:

Dear customer,  
please cooperate in avoiding waste. When you intend to dispose of the product in future, please consider that it contains valuable raw materials suited for recycling.  
Therefore, do not dispose it of with domestic waste but bring it to a collection point for the recycling of waste electrical and electronic equipment.  
Thank you very much for your cooperation!



Copyright, esotec GmbH

## 9. Safety information:

**DANGEROUS for children!** Children could easily swallow the small parts that come with this pump and its packaging material. Please keep at a safe distance. These parts could otherwise lead to choking or suffocation!

**WARNING against danger of stumbling!** Lay out the connection cable such that it does not create the threat of tripping or stumbling!

**CAREFUL: material damage!** If you set up the solar module without a module holder, you must make sure that it is sturdy enough to retain its position. If the module falls down or a foreign object hits against it, the solar module can be damaged.