

# Operating Instructions

## Deko Cordlight 450 LED



### Customer support:

If you have problems or questions regarding this product, simply contact us!

By phone: +49 9605-92206-0

By e-mail for ordering spare parts: [ersatzteil@esotec.de](mailto:ersatzteil@esotec.de)

By e-mail for questions about the product: [technik@esotec.de](mailto:technik@esotec.de)

Product: Manufacturer Item No.: 202026

These instructions relate **ONLY** to this product and contain important information for using the product for the first time. Please keep these instructions for later reference and should always accompany the product in the event of transference to a new user.

## 1. Introduction

Dear Customer,

Thank you for purchasing the solar light. With this solar light you purchased a product manufactured according to the current state of technology.

**CE** This product fulfils all requirements of the valid European and national regulations. The conformity was proved. The relevant declarations and documentation are deposited with the manufacturer.

To maintain this state and guarantee a safe operation, you as the user will have to follow this operating manual!

## 2. Safety Instructions



- In case of damages caused by not following this operating manual, the warranty rights will expire! We exclude liability for any consequential damages!
- We exclude liability for property or personal damages caused by inappropriate handling or not following the safety instructions.
- In these cases any guarantee rights will expire.

Due to safety and admission reasons (CE) it is not allowed to arbitrarily reconstruct and/or change the solar light.

Therefore, please keep to the operating manual.

The accident prevention rules of the association of the industrial trade cooperative association for electric plants and working material are to be considered in industrial environments.

## 3. Intended Use and Function

The decorative light is designed for use in indoor or rain-protected outdoor areas.

The lamp is powered by 2 pcs. 1.5 V alkaline batteries (AA, Mignon) (not included). These batteries must be replaced in pairs after discharge.

As light source a light chain with 60 LEDs is worked into the rope.

The candle can be operated in the operating modes continuous light (ON) or timer (TIMER). In the continuous light position (ON), the candle lights up until the battery is completely discharged.

In the timer function (TIMER), the light chain lights up for 6 hours from the time the switch is pushed into the "Timer" position. After 18 hours the candle will light up again for 6 hours. This function allows a much longer period of use with one set of batteries. Please follow the instructions in point 5 for the settings.

## 4. Putting into Operation

1. Remove the lamp carefully from its packaging.
2. Open the battery compartment (fig. 1) and insert both batteries correctly.



**Note:** Never use different fully charged batteries. This reduces the flash time enormously or the lamp does not light up at all!

3. Slide the switch on the battery housing into the desired operating mode ("ON" or "TIMER").

## 5. Operating Modes (ill. 2)

### Continuous operation (ON):

In this switch position, the light chain lights up continuously until it is switched off again or the batteries are completely discharged.

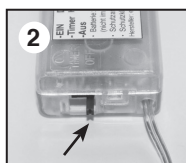

### Timer function (TIMER):

In this switch position, the lamp lights up for 6 hours in timer mode from the moment it is switched on. The light then switches itself off. After 18 hours, the light automatically switches on again for a further 6 hours. This works until the light is switched off or the batteries are completely discharged.

The deco light is now activated and ready for use!

## 6. Exchange of the Batteries

In the deco light, the alkaline batteries must be replaced after discharging. Please insert only new alkaline batteries of the same construction.

1. Slide the switch on the battery housing to the "OFF" position (Fig. 3).
2. Slide the battery compartment cover to the side and remove it (Fig. 4).
3. Remove the batteries from the holder and insert new, identical alkaline batteries (Mignon, AA) with the correct polarity.
4. Close the battery cover (fig. 4).
5. Slide the switch back to the desired position (fig. 3).

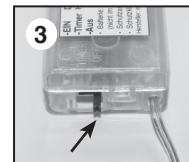

**Note:** Used batteries or accumulators must be disposed of in a non-polluting way and do not belong into the domestic waste. Your dealer is legally obliged to take back the old accumulators.

## 7. Malfunctions

### Lamp does not switch on in timer mode

- Battery weak or defective? Exchange of the battery.
- Is the lamp in the 18 h standby period?

The lamp is not switched at all or only for a short time.

- Is the lamp activated/switched on?
- Batteries weak or defective? Exchange of the batteries.

## 8. Technical Data

- Illuminant: 60 warm white light emitting diode (LED)
- Batteries: Alkaline 1.5 V (Mignon, AA). Not included in the delivery!
- Protection type: IP 20
- Protection class: III
- Luminescing time in timer mode: 6 h

### Battery notes

- Batteries should not be played with by children. Never leave batteries lying around; they could be swallowed by children or pets.
- Batteries must never be short-circuited, disassembled or thrown into fire. This leads to a danger of explosion!
- Leaking or damaged batteries can cause chemical burns when they come into contact with skin. For this reason, please make use of suitable protective gloves.
- Batteries should only be replaced by structurally identical batteries.
- Make sure the batteries are inserted with the correct polarity.
- For long periods of time of non-use (for example, storage), remove the inserted batteries to avoid damages via the leaking batteries.

### Battery take-back

- Batteries must not be discarded into domestic waste.
- The consumer is legally required to return batteries after use, e.g. to public collecting centers or to battery distributors.
- Contaminant-containing batteries are labeled with the sign "crossed-out trashcan" and one of the chemical symbols. Used batteries should be disposed environmentally friendly and should not be discarded into domestic waste. Your dealer is legally required to take back old batteries.



### Manufacturer / Importer

esotec GmbH - Gewerbegebiet Weberschlag 9 - D-92729 Weiherhammer  
Tel.-Nr: +49 9605-92206-0 Fax.-Nr: +49 9605-92206-10  
Internet: [www.esotec.de](http://www.esotec.de) WEEE-Nr: DE 59284711

### Disposal:

Dear customer,  
please cooperate in avoiding waste. When you intend to dispose of the product in future, please consider that it contains valuable raw materials suited for recycling.

Therefore, do not dispose it of with domestic waste but bring it to a collection point for the recycling of waste electrical and electronic equipment.

Thank you very much for your cooperation!



Copyright, esotec GmbH