

Operating instructions

Solar floor lamp Power Globe 20



- Now close the hole.
- Plug the lamp onto the stand and make sure that the threaded hole is in the correct position.
- Screw the screw back in.
- Now place the lamp in a sunny and shadow-free location.

4.2 The IR remote control

To activate the remote control, simply pull out the plastic strip on the bottom.

To control the light colour, the remote control must be held at a distance of approx. 50 cm from the top of the sphere. The following functions can be controlled via the remote control:



- White:** Light colour cold white
Warm White: Light colour warm white
OFF: Lamp switched off

The solar light is now activated and ready for use!

Note:

The lighting duration is strongly dependent on the intensity and duration of the solar radiation during the day. In days with little sunshine, generally less lighting duration is to be expected. If the light does not light up on the first evening, please wait for a sunny day.

Customer support:

If you have problems or questions regarding this product, simply contact us!

Internet: www.esotec.de

By phone: +49 9605-92206-0

By e-mail for ordering spare parts: ersatzteil@esotec.de

By e-mail for questions about the product: technik@esotec.de

Product: Manufacturer Item No.: 102432

These instructions relate **ONLY** to this product and contain important information for using the product for the first time. Please keep these instructions for later reference and should always accompany the product in the event of transference to a new user.

1. Introduction

Dear Customer,

Thank you for purchasing the solar light.

With this solar light you purchased a product manufactured according to the current state of technology.



This product fulfils all requirements of the valid European and national regulations. The conformity was proved. The relevant declarations and documentation are deposited with the manufacturer.

To maintain this state and guarantee a safe operation, you as the user will have to follow this operating manual!

2. Safety Instructions



- In case of damages caused by not following this operating manual, the warranty rights will expire! We exclude liability for any consequential damages!
- We exclude liability for property or personal damages caused by inappropriate handling or not following the safety instructions.
- In these cases any guarantee rights will expire.

Due to safety and admission reasons (CE) it is not allowed to arbitrarily reconstruct and/or change the solar light.

Therefore, please keep to the operating manual. The accident prevention rules of the association of the industrial trade cooperative association for electric plants and working material are to be considered in industrial environments

3. Intended use and function

The solar light is designed for year-round outdoor use. It can be placed on terraces, in gardens, entrance areas etc.

The built-in rechargeable battery is optimally charged at any angle of incidence due to an intelligent arrangement of the solar cells. The light switches on automatically at dusk and off again at dawn. 30 warm white and 30 cold white LEDs are installed as light sources. These enable optimum illumination of the sphere. The light colour can be selected via an IR remote control between warm or cold white. The light switches off automatically after 8 hours of operation or when the battery is discharged.

During longer periods without sunlight, the battery is insufficiently charged to ensure constant readiness for operation. However, this does not mean that the solar light is defective. Wait for the next sunny day and the lamp will work again accordingly, or recharge the battery in a standard charger in between.

4. Commissioning

4.1 The lamp

Carefully remove the lamp from the packaging and follow the description below:

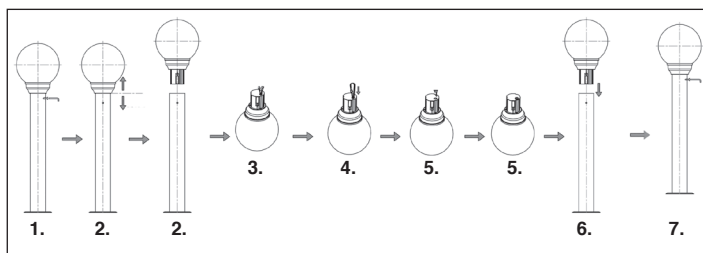

- Unscrew the screw.
- Remove the lamp upwards.
- Place the lamp on its head
- Plug the plug and the socket of the battery cable together and insert the cable with connector through the hole into the inside of the housing.
Note: This plug connection is protected against reverse polarity. Please do not use force!

5. Changing the battery

For solar lights, the battery must be replaced every 3 years on average. Please use only an identical battery with the same voltage and capacity. If you do not get this capacity, you can also use batteries with higher capacity.

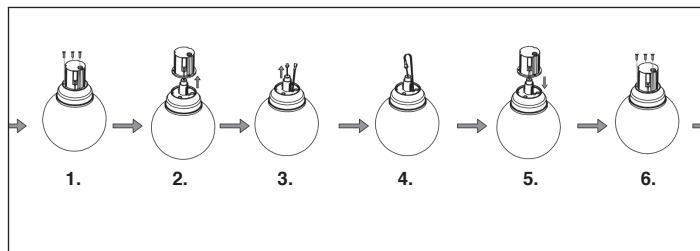

Remove the ball as described in point 4.1.

Proceed as described below to replace the battery:

- Unscrew the three screws at the bottom.
- Remove the cover carefully.
- Remove the used battery from the holder.
- Loosen the plug connection of the battery and reconnect the plug connection with the new battery.
Note: This plug connection is protected against reverse polarity. Please do not use force!
- Now reinsert the new battery and replace the cover.
- Now screw the 3 screws back in.
- Now remount the lamp as described under point 4.1.

Note: Used batteries or rechargeable batteries must be disposed of in an environmentally friendly manner and do not belong in the household waste. Your dealer is legally obliged to take back the old batteries.

6. Malfunctions

1. The light colour of the sphere cannot be controlled with the remote control!

Remedy: Is the plastic strip on the underside of the remote control removed (only for initial operation)?

Remedy: Please note that the sphere can only be remote controlled at night!

Remedy: Is the battery in the remote control too weak or exhausted? Replace battery with an identical type!

Remedy: No sunshine during the day. If the sky is cloudy without sunshine, the built-in battery in the sphere is not sufficiently charged! Wait for a sunny day!

Remedy: This is an IR remote control. To control the sphere, please align the remote control with the sphere.

2. No light in the Sphere!

Remedy: Has the battery in the light ball reached the end of its service life (replace at least every 2 years!)?

Remedy: No sunshine during the day. If the sky is cloudy without sunshine, the battery in the sphere is not sufficiently charged! Wait for a sunny day!

Remedy: Light activated? See instructions point 4.1?

Remedy: Light switched off via remote control?

Remedy: An extraneous light source (e.g. street lamp) simulates daylight and prevents the light from being switched on. Place the lamp in a darker place.

7. Technical data

- Solar module: 0.6 Wp
- Light source: 30 warm white and 30 cold white LEDs
- Light colours: 3000 K/ 6500 K
- luminous intensity: 20/ 30 lm
- Light duration: After 8 hours automatic switch-off
- Battery: Li-Fe 3.2 V/ 1500 mAh (spare part no: 901053)
- Protection class: IP 65
- Protection class: III
- Lighting time: max. 8 hours with full battery
- Remote control: Battery: CR2025 Lithium 3 V

Rechargeable battery notes

- Rechargeable batteries should not be played with by children. Never leave rechargeable batteries lying around; they could be swallowed by children or pets.
- Rechargeable batteries must never be short-circuited, disassembled or thrown into fire. This leads to a danger of explosion!
- Leaking or damaged rechargeable batteries can cause chemical burns when they come into contact with skin. For this reason, please make use of suitable protective gloves.
- Rechargeable batteries should only be replaced by structurally identical rechargeable batteries from the same manufacturer. Normal batteries must not be used since these are not rechargeable.
- Make sure the rechargeable batteries are inserted with the correct polarity.
- For long periods of time of non-use (for example, storage), remove the inserted rechargeable batteries to avoid damages via the leaking rechargeable batteries.

Manufacturer/Importer:

esotec GmbH - Gewerbegebiet Weberschlag 9 - D-92729 Weiherhammer
Tel.-Nr: +49 9605-92206-0 - Fax.-Nr: +49 9605-92206-10 - Internet: www.esotec.de

Disposal:

Dear customer,
please cooperate in avoiding waste. When you intend to dispose of the product in future, please consider that it contains valuable raw materials suited for recycling.

Therefore, do not dispose it of with domestic waste but bring it to a collection point for the recycling of waste electrical and electronic equipment.

Thank you very much for your cooperation!

Copyright, esotec GmbH



Battery Recycling:

- Used batteries or accumulators must be disposed in the domestic waste.
- The consumer is legally obliged to bring back old accumulators upon usage, e.g. to public waste collecting locations or to the place (shops, etc.) where those batteries are sold.
- Batteries that contain harmful substances are marked with the "strike through dustbin" and one of the chemical symbols.



NiMh