

Instruction manual

Solar Housenumber Alu-Line



Customer support:

If you have problems or questions regarding this product, simply contact us!
esotec GmbH, Industriegebiet Weberschlag 9, D-92729 Weiherhammer

By phone: +49 9605-92206-0

By e-mail for ordering spare parts: ersatzteil@esotec.de

By e-mail for questions about the product: technik@esotec.de

Manufacturer Item No.: 102650 Alu-Line black, 102651 Alu-Line nature

Battery take-back

- Batteries must not be discarded into domestic waste.
- The consumer is legally required to return batteries after use, e.g. to public collecting centers or to battery distributors.
- Contaminant-containing batteries are labeled with the sign "crossed-out trashcan" and one of the chemical symbols. Used batteries should be disposed environmentally friendly and should not be discarded into domestic waste. Your dealer is legally required to take back old batteries.

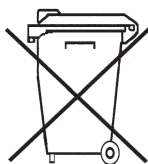

Li-Fe

Rechargeable battery notes

- Rechargeable batteries should not be played with by children. Never leave rechargeable batteries lying around; they could be swallowed by children or pets.
- Rechargeable batteries must never be short-circuited, disassembled or thrown into fire. This leads to a danger of explosion!
- Leaking or damaged rechargeable batteries can cause chemical burns when they come into contact with skin. For this reason, please make use of suitable protective gloves.
- Rechargeable batteries should only be replaced by structurally identical rechargeable batteries from the same manufacturer. Normal batteries must not be used since these are not rechargeable.
- Make sure the rechargeable batteries are inserted with the correct polarity.
- For long periods of time of non-use (for example, storage), remove the inserted rechargeable batteries to avoid damages via the leaking rechargeable batteries.

Disposal:

Dear customer,
please cooperate in avoiding waste. When you intend to dispose of the product in future, please consider that it contains valuable raw materials suited for recycling. Therefore, do not dispose it of with domestic waste but bring it to a collection point for the recycling of waste electrical and electronic equipment.



Thank you very much for your cooperation!

1. Introduction

Dear customer, we thank you for purchasing the Solar Globelight. With this Solar Light you have purchased a product that complies with the latest and most up-to-date technology.



This product complies with the European and National Standards. The relevant certificates of conformity are deposited with the manufacturer.

To preserve this standard and in order to maintain safety you must adhere to the use instructions!

2. Security Instructions



In the event of any problems arising or damage occurring from not following these instructions, the warranty is deemed cancelled. The manufacturer will not be held responsible for any claims or damages arising from the misuse of this product.

- For safety reasons and in order to maintain standards (CE) you are prohibited from altering or changing any component in the product.
- Please follow the instructions very carefully.
- For commercial applications due care and attention must be paid to the Health and Safety Standards in your jurisdiction.

3. Function and intended use

The solar house number light is designed for year-round outdoor use. It is made of high-quality materials and thus guarantees a long function over many years.

The powerful solar module is designed in shingle technology, the solar house number light must be mounted on a shadow-free sunny wall. A south, east or west side is recommended. Shady north sides or the assembly under a shady roof projection are not suitable for solar house number lights.

The built-in battery is charged by the solar module installed in the upper part. The solar module consists of high-quality crystalline solar cells with space-saving shingle technology and is laminated absolutely weatherproof behind glass.

The house number can be set between the light colours warm white or cold white using an enclosed IR remote control. It is also possible to switch it ON or OFF.

At night the light switches on automatically and illuminates the number with a weak light. If a movement is registered by the PIR sensor, the light illuminates with maximum luminosity for approx. 20 seconds after the last movement.

Powerful light emitting diodes (LEDs) are used as the light source. These LEDs guarantee high luminosity with low power consumption and a service life of over 30,000 hours.

Note: During longer periods without sunlight, the battery is insufficiently charged by the sunlight and the lamp does not work in the evening. However, this does not mean that the solar light is defective. Wait for the next sunny days and the lamp will work again accordingly.

The battery should be changed every 3-4 years on average!

4. Commissioning

1. Carefully remove the parts from the packaging.
2. Determine the location of the solar house number light. It must be a shadow-free, sunny place. We recommend south, east or west sides. North sides are not suitable for solar house number lights!

3. Stick your house number onto the white surface of the solar house number light using the enclosed letters and numbers.

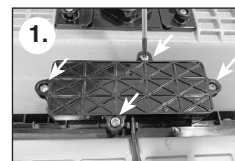

4. Unscrew the 4 screws on the back of the solar house number light with a suitable screwdriver (pic. 1) and remove the cover.

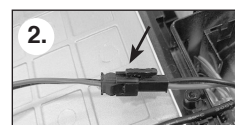

5. Remove the battery from the transport box and connect the socket on the battery cable with the plug on the cable of the circuit board (pic. 2).

Note: The plug is protected against reverse polarity! Please do not use force!

6. Now carefully insert the battery into the battery compartment and stow the cable (pic. 3).

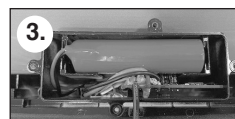

7. Now place the cover of the battery compartment so that the two arrows look at each other (pic.).

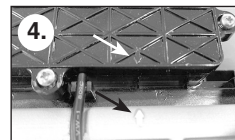

8. Turn the 4 screws back in with a suitable screwdriver.

9. Now mount the plastic holder on the wall with the 3 screws provided (pic. 5) and mount the house number light (pic. 6 rear view).

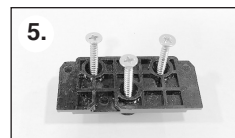

10. Now secure the solar house number light by falling down or stealing it with the help of the threaded screw (pic. 7 rear view).

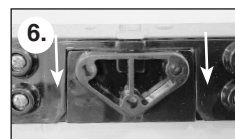

11. Now pull the plastic strip out of the battery compartment of the IR remote control.

12. In darkness you can now set the light colour of the solar house number light by pressing the corresponding button or switch off the solar house number light. To do this, hold the IR remote control in the direction of the illuminated area of the solar house number light!

Note: The battery is also charged in the „OFF“ position!

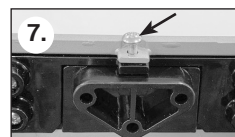

Note: The duration of the light depends strongly on the intensity and duration of sunlight during the day. In the winter months you should generally reckon with less light duration. If the lamp does not yet light up on the first evening, please wait for a sunny day.

5. Changing the battery

On average, the batteries in the solar module must be replaced every 3-4 years by new batteries of the same type and design. A Li-Fe battery 3.2 V/ 1500 mAh is used here. You receive the spare accumulator with your dealer or with the manufacturer under www.esotec.de

Please proceed as follows when exchanging the battery:

1. Press the OFF button on the remote control and switch off the solar house number light.
2. Loosen the locking screw and remove the solar house number light.
3. Loosen the 4 screws of the cover at the back (pic. 8) of the solar house number light with a suitable screwdriver and remove the cover.
4. Remove the used battery from the battery compartment and release the connection by pressing the lock (pic. 9) on the plug and releasing the plug connection.
5. Now take a new battery of the same construction and reconnect the plug connection (pic. 9).
Note: The plug is protected against reverse polarity! Please do not use force!
6. Now carefully insert the battery into the battery compartment and stow the cable (pic. 10).
7. Now place the cover of the battery compartment so that the two arrows look at each other (pic. 11).
8. Turn the 4 screws in again with a suitable screwdriver.
9. Replace the house number light.
10. Now secure the solar house number light by falling down or stealing it with the help of the threaded screw.
11. Now set the desired light colour with the IR remote control at night.

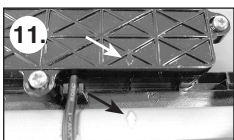
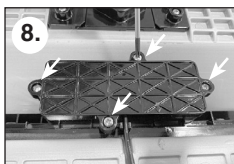

Note: Used batteries or accumulators must be disposed of in an environmentally friendly manner and should not be disposed of with household waste. Your dealer is legally obliged to take back the old batteries.

6. IR remote control

The IR remote control allows the light colour of the LEDs to be easily changed from the outside without removing the luminaire. Hold the IR remote control against the illuminated surface and press the desired button (Fig. 12).

1 = White means light colour **cold white**

2 = Warm White means light colour **warm white**

OFF = **Lamp switched off** (battery will still be charged!)

The transparent fuse strip in the battery compartment must be pulled out when the unit is put into operation for the first time. After some time, the battery in the IR remote control is exhausted and must be replaced. Simply push in the lock on the battery compartment of the IR remote control on the side and pull out the battery compartment (Fig. 13). Replace the battery with a new one of the same size (CR2025, 3 V/ Lithium) and slide the battery compartment back into the IR remote control.

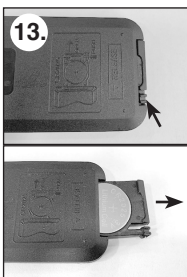
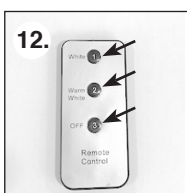

7. Malfunctions

Lamp does not switch on at night!

Remedy: Is the solar module illuminated by extraneous light (e.g. spotlight)? Position the solar house number light in a darker place!

Remedy: Is the luminaire switched on?

Remedy: Has the security strip been removed from the IR remote control?

Remedy: Is the battery in the IR remote control exhausted?

Remedy: Has the battery in the lamp reached the end of its service life? As a rule, the batteries must be replaced with identical types every 3-4 years!

Remedy: Is the solar module illuminated by extraneous light (e.g. spotlight)? Position the solar module in a darker place!

7. Technical data

- Solar module: 2.2 Wp crystalline Shingle technology
- Illuminant: 10 warm white LEDs
10 cold white LEDs
- Light colours: warm white 3000 K, cool white: 6000 K
- Brightness: warm white 18 lm, cool white: 20 lm
- Brightness during movement: 60 lm
- Afterglow time: approx. 20 sec. after last movement
- Lighting duration: approx. 12 hours with fully charged battery
- PIR sensor: 120°/ 5-8 m
- Replacement battery: Li-Fe 3.2 V/ 1500 mAh (type 18650)
- esotec spare part no.: 901051
- Protection class: IP 54
- Protection class: III
- Battery remote control: CR2025, 3 V Lithium

All spare parts can be found at www.esotec.de

Copyright esotec GmbH, subject to alterations!