

Instruction manual



Solar Flood Light Pro RGB

Customer support:

If you have problems or questions regarding this product, simply contact us!
esotec GmbH, Industriegebiet Weberschlag 9, D-92729 Weiherhammer

By phone: +49 9605-92206-0

By e-mail for ordering spare parts: ersatzteil@esotec.de

By e-mail for questions about the product: technik@esotec.de

Product: Manufacturer Item No.: 102703

Battery take-back

- Batteries must not be discarded into domestic waste.
- The consumer is legally required to return batteries after use, e.g. to public collecting centers or to battery distributors.
- Contaminant-containing batteries are labeled with the sign "crossed-out trashcan" and one of the chemical symbols. Used batteries should be disposed environmentally friendly and should not be discarded into domestic waste. Your dealer is legally required to take back old batteries.

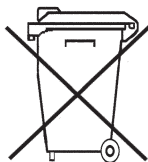

Li-Ion

Rechargeable battery notes

- Rechargeable batteries should not be played with by children. Never leave rechargeable batteries lying around; they could be swallowed by children or pets.
- Rechargeable batteries must never be short-circuited, disassembled or thrown into fire. This leads to a danger of explosion!
- Leaking or damaged rechargeable batteries can cause chemical burns when they come into contact with skin. For this reason, please make use of suitable protective gloves.
- Rechargeable batteries should only be replaced by structurally identical rechargeable batteries from the same manufacturer. Normal batteries must not be used since these are not rechargeable.
- Make sure the rechargeable batteries are inserted with the correct polarity.
- For long periods of time of non-use (for example, storage), remove the inserted rechargeable batteries to avoid damages via the leaking rechargeable batteries.

Disposal:

Dear customer,
please cooperate in avoiding waste. When you intend to dispose of the product in future, please consider that it contains valuable raw materials suited for recycling.
Therefore, do not dispose it of with domestic waste but bring it to a collection point for the recycling of waste electrical and electronic equipment.



Thank you very much for your cooperation!

1. Introduction

Dear customer, we thank you for purchasing the Solar Globelight. With this Solar Light you have purchased a product that complies with the latest and most up-to-date technology.



This product complies with the European and National Standards. The relevant certificates of conformity are deposited with the manufacturer.

To preserve this standard and in order to maintain safety you must adhere to the use instructions!

2. Security Instructions



In the event of any problems arising or damage occurring from not following these instructions, the warranty is deemed cancelled. The manufacturer will not be held responsible for any claims or damages arising from the misuse of this product.

- For safety reasons and in order to maintain standards (CE) you are prohibited from altering or changing any component in the product.
- Please follow the instructions very carefully.
- For commercial applications due care and attention must be paid to the Health and Safety Standards in your jurisdiction.

3. Function and intended use

The solar radiator is designed for year-round outdoor operation. It is made of high-quality materials and thus guarantees a long function over many years.

The solar module must be set up shadow-free to the sun. It can be mounted with a ground spike or via a mounting bracket with screws. A south, east or west side is recommended. Shady north sides are not suitable for solar lights.

The built-in batteries are charged by the solar module installed in the upper part. The solar module consists of high-quality crystalline solar cells and is laminated absolutely weatherproof behind glass.

The radiator is connected to the solar module via a cable with plug connection. It can be mounted on the wall by means of a ground spike in the floor or mounting bracket with screws. 24 RGB light emitting diodes (LEDs) are used as the light source. These LEDs guarantee high luminous intensity with low power consumption and a service life of over 30,000 hours. The spotlight must not be submerged in water!

The product can be used outdoors throughout the year. The solar module must be kept free of snow.

Note: During longer periods without sunlight, the battery is insufficiently charged by the sunlight and the lamp does not work in the evening. **However, this does not mean that the solar light is defective.** Wait for the next sunny days and the lamp will work again accordingly.

The battery should be changed every 3-4 years on average!

4. Commissioning

1. Carefully remove the parts from the packaging.
2. Determine the mounting location of the solar module and spotlight within reach of the cable. The spotlight and the solar module can either be screwed to the wall using screws (picture 1) or plugged into the ground using a ground spike (picture 2).
3. After installation, connect the cable of the solar module and the radiator to each other. Then secure the plug connection additionally with the union nut (picture 3)!
4. Press the „ON/OFF“ switch on the back of the solar module (Fig. 4) firmly.
5. The light colours can be set either as **alternating** light or **continuous** light. The switch on the underside of the spotlight is used for adjustment. If the switch is pressed in (picture 5), the alternating light is activated. To determine the desired light colour, simply press the switch again, then the corresponding light colour is fixed (picture 6).

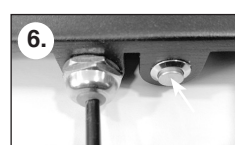
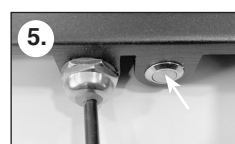
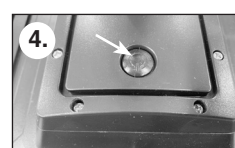
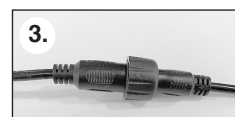
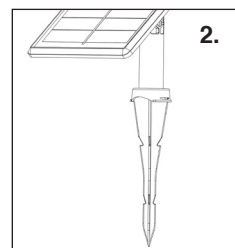
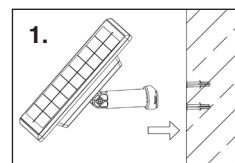

Note: In OFF-position the battery is also charged during sunshine!

Note: The duration of the light depends strongly on the intensity and duration of sunlight during the day. In the winter months you should generally reckon with less light duration. If the lamp does not yet light up on the first evening, please wait for a sunny day.

Note: The cover of the spotlight and the solar module is made of glass. There is a risk of injury in the event of breakage!

5. Changing the battery

On average, the batteries in the solar module must be replaced every 3-4 years by new batteries of the same type and design. Here 2 Li-Ion batteries with 3.7 V/ 2000 mAh are used. You receive the spare accumulators with your dealer or with the manufacturer under www.esotec.de

Please proceed as follows when exchanging the batteries:

1. Press the „ON/OFF“-switch at the back of the solar module firmly in (picture 4) and switch off the lamp.
2. Release the plug connection between the solar module and the LED spotlight.
3. Loosen the screws of the cover on the back of the solar module (picture 7) and remove the cover.

Note: This battery compartment can hold up to 3 batteries. In this version, however, only 2 batteries are used. One battery compartment remains empty!

4. Remove the two batteries carefully from the battery compartment (picture 8) and insert 2 new batteries of the same construction into the battery compartment with the **correct polarity** (battery type used: Li-Ion 3.7 V/ 2000 mAh).
6. Now put the lamp back into operation in reverse order.

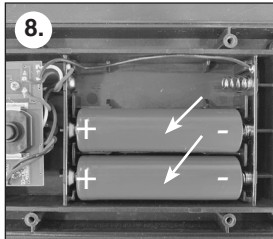
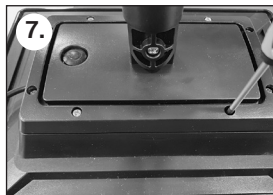

Note: Used batteries or accumulators must be disposed of in an environmentally friendly manner and should not be disposed of with household waste. Your dealer is legally obliged to take back the old batteries.

6. Malfunctions

Lamp does not switch on at night!

Remedy: Is the switch at the rear of the solar module switched on?

Remedy: Battery in the lamp has reached the end of its service life? As a rule, the batteries must be replaced with identical types every 3-4 years!

Remedy: Is the solar module illuminated by extraneous light (e.g. spotlight)? Position the solar module in a darker place!

7. Technical data

- | | |
|---------------------------|---|
| • Solar module: | 5 Wp crystalline |
| • Illuminant: | 24 RGB-LEDs |
| • Light colours: | Alternating or fixed |
| • Lighting duration: max. | 12 hours with fully charged battery |
| • Replacement battery: | 2 pcs. Li-ion 3.7 V/ 2000 mAh (type 18650)
esotec spare part no.: 901045 |
| • Protection class: | IP 54 |
| • Protection class: | III |

All spare parts can be found at www.esotec.de

Copyright esotec GmbH, Änderungen vorbehalten!