

Using Instructions

Under water light „Splash“



These instructions relate **ONLY** to this product and contain important information for using the product for the first time. Please keep these instructions for later reference and should always accompany the product in the event of transference to a new user.

1. Introduction

Dear Customer,
Thank you for purchasing the solar light. With this solar light you purchased a product manufactured according to the current state of technology.

CE This product fulfils all requirements of the valid European and national regulations. The conformity was proved. The relevant declarations and documentation are deposited with the manufacturer.

To maintain this state and guarantee a safe operation, you as the user will have to follow this operating manual!

2. Safety Instructions



- In case of damages caused by not following this operating manual, the warranty rights will expire! We exclude liability for any consequential damages!
- We exclude liability for property or personal damages caused by inappropriate handling or not following the safety instructions.

- In these cases any guarantee rights will expire.

Due to safety and admission reasons (CE) it is not allowed to arbitrarily reconstruct and/or change the solar light.

Therefore, please keep to the operating manual.

The accident prevention rules of the association of the industrial trade cooperative association for electric plants and working material are to be considered in industrial environments.

3. Usage in Accordance with Requirements

At darkness, the solar underwater beamer/spotlight is automatically switched on and switched out at sunrise. The maximum duration of illumination with full (rechargeable) battery and without recharge is approx. 8 hours. The solar module installed in the upper part of the housing charges the installed rechargeable batteries. The lighting is switched on and off via a switch. The three underwater spotlights are suitable for the outdoor and under-water use. The spotlights may be sunk in the garden pond, a well or similar. This is done by means of a plate holder which is filled with stones. The solar module may be mounted into the ground with a earth spike or screwed to a wall. The product is designed for the use in private households.

Note: Please make sure that the solar module is preferably directed to the South and that shadows are avoided. When directing the module to the North it is not possible to use the product. The solar module shall always be free of snow in the winter.

4. Initiation

1. Please carefully take all parts out of the package and unwrap the accessories.

2. The three LED-light rings may be inserted on the plate holders. This plate may then be filled with stones. Their weight will ensure a better fixing in the pond.

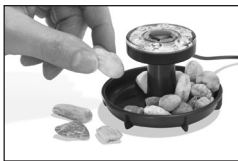

3. Now choose an appropriate site for the assembly of the solar module within the reach of the spotlight. Please note that the solar module site shall be directed to the south and that no shadow falls on the solar module. By means of an assembly plate, the solar module may be screwed to a wall or floor, or, via an earth pole, inserted into the ground. Via the ball-and-socket joint, it is possible to direct the solar module to the sun.

4. Now, connect the 3 plugs (pic. 4) of the spotlight with the sockets on the cable from the solar module.

Note: Those are humidity-protected plugs. Put the plugs together completely.

5. Now set the switch (pic. 5) on the back side of the solar module to the position "ON". The solar spotlights are now activated.

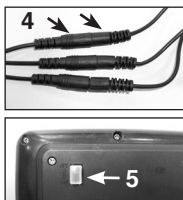
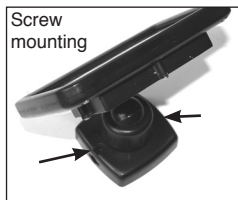

Note: During the winter months the duration of illumination will generally be shorter. If the lamp should not shine on the first evening, please wait for a sunny day.

5. Exchange of Accumulators

After one to two years, the capacity of the accumulator pack will decrease. It is then required to exchange the accumulators. The accumulators are available in the shops or from the manufacturer.

1. Unscrew the 4 screws on the back side of the solar module and take off the cover.
2. Take the accumulator from the mounting bracket
3. Insert the new accumulator with correct polarity and close the housing in reverse order.

Note: Use batteries or accumulators must be disposed of in a non-polluting way and do not belong into the domestic waste. Your dealer is legally obliged to take back the old accumulators.



6. Malfunctions

- **Lamp is not automatically switched on at darkness**
- An outside light source (e.g. streetlight) simulates daylight and prevents the lamp from switching on. Place the lamp at a darker location.
- **Lamp is not switched on at darkness or only for a short period of time.**
- Is the lamp strong connected?
- Accumulator weak or defective. Exchange of the accumulators.

7. Specifications

- Operating voltage: 3,6 V
- Power Solarmodule: 1 Wp
- Protection class: III
- Degree of protection: solar module IP 44, underwater beamer/spotlight: IP 68
- Battery: 3 pcs. NiMH 1.2 V/900 mAh AA-size
- Illuminating units: 18 white LEDs
- Lighting color: item-no: 102148: 6000 K, item-no: 102149: 3000 K
- Light intensity: item-no: 102148: 3 x 22 lm, item-no: 102149: 3 x 20 lm
- Illumination time: max. 8 h with a full battery

Battery take-back

- Batteries must not be discarded into domestic waste.
- The consumer is legally required to return batteries after use, e.g. to public collecting centers or to battery distributors.
- Contaminant-containing batteries are labeled with the sign "crossed-out trashcan" and one of the chemical symbols. Used batteries should be disposed environmentally friendly and should not be discarded into domestic waste. Your dealer is legally required to take back old batteries.

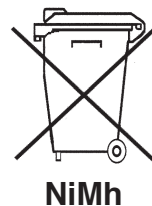

Rechargeable battery notes

- Rechargeable batteries should not be played with by children. Never leave rechargeable batteries lying around; they could be swallowed by children or pets.
- Rechargeable batteries must never be short-circuited, disassembled or thrown into fire. This leads to a danger of explosion!
- Leaking or damaged rechargeable batteries can cause chemical burns when they come into contact with skin. For this reason, please make use of suitable protective gloves.
- Rechargeable batteries should only be replaced by structurally identical rechargeable batteries from the same manufacturer. Normal batteries must not be used since these are not rechargeable.
- Make sure the rechargeable batteries are inserted with the correct polarity.
- For long periods of time of non-use (for example, storage), remove the inserted rechargeable batteries to avoid damages via the leaking rechargeable batteries.

manufacturer/distributor respectively importer/ customer service/ spare parts:

esotec GmbH - Weberschlag 9 - D-92729 Weiherhammer
Tel.-Nr: +49 9605-92206-0 Fax.-Nr: +49 9605-92206-10
e-mail: info@esotec.de Internet: www.esotec.de

Under water light Splash cold white: Product item-Nr: 102148
Under water light Splash warm white: Product item-Nr: 102149

Disposal:

Dear customer,
please cooperate in avoiding waste. When you intend to dispose of the product in future, please consider that it contains valuable raw materials suited for recycling.
Therefore, do not dispose of it with domestic waste but bring it to a collection point for the recycling of waste electrical and electronic equipment.

Thank you very much for your cooperation!

