

# Using Instructions „Trio PIR“



These instructions relate **ONLY** to this product and contain important information for using the product for the first time. Please keep these instructions for later reference and should always accompany the product in the event of transference to a new user.

## 1. Introduction

Dear Customer,  
Thank you for purchasing the solar light. With this solar light you purchased a product manufactured according to the current state of technology.



This product fulfils all requirements of the valid European and national regulations. The conformity was proved. The relevant declarations and documentation are deposited with the manufacturer.

To maintain this state and guarantee a safe operation, you as the user will have to follow this operating manual!

## 2. Safety Instructions



- In case of damages caused by not following this operating manual, the warranty rights will expire! We exclude liability for any consequential damages!
- We exclude liability for property or personal damages caused by inappropriate handling or not following the safety instructions.

- In these cases any guarantee rights will expire.

Due to safety and admission reasons (CE) it is not allowed to arbitrarily reconstruct and/or change the solar light.

Therefore, please keep to the operating manual.

The accident prevention rules of the association of the industrial trade cooperative association for electric plants and working material are to be considered in industrial environments.

## 3. Usage in Accordance with Requirements

The solar spotlight may be operated with or without movement-sensitive switch. If the movement-sensitive switch is plugged-in, the light will automatically be switched-on in the dark as soon as any motion is detected (thermal change) and will remain switched-on for approx. 30 sec. after the last motion was detected.

If the movement-sensitive switch is not plugged-in, the light will automatically be switched-on in the dark and switched-off at morning light.

The maximum illumination duration with a full accumulator and without recharging is approximately 8 hours. The solar module installed in the upper part of the housing charges the integrated accumulator.

The illumination may be switched on and off via a switch. The three solar spotlights are suitable for outdoor usage. The spotlights must not be sunk into water. With the earth pole, it is possible to insert the spotlights into the ground or, by means of a mounting bracket, screw them to a wall. The solar module may be installed on a pole, inserted into the ground or screwed to the wall. The product is designed for the application in a private environment.

Note: Please make sure that the solar module is preferably directed to the South and that shadows are avoided. When directing the module to the North it is not possible to use the product. The solar module shall always be free of snow in the winter.

## 4. Initiation

1. Please carefully take all parts out of the package and unwrap the accessories.

2. Via an earth pole, it is possible to insert the three LED spotlights into the ground or, by means of an assembly plate, screwed to a wall or floor. The spotlight may be adjusted via the ball-and-socket joint. The PIR switch may additionally be mounted higher by means of a plastic pipe. This will increase the sensor's range. The spotlights and the movement-sensitive switch may be adjusted optimally via the ball joint. The spotlight may be operated with or without PIR switch. In the last case, the lamps will be switched-on at dusk and switched-on at dawn or in case the storage battery is empty.



earth pole



3. Now choose an appropriate site for the assembly of the solar module within the reach of the spotlight. Please note that the site shall be directed to the south and that no shadow falls on the solar module. By means of an assembly plate, the spotlight may be screwed to a wall or floor, or, via an earth pole, inserted into the ground. The spotlight may also be installed on a post. This is done by means of a pole bracket. Via the ball-and-socket joint, it is possible to direct the spotlight to the sun.



earth pole

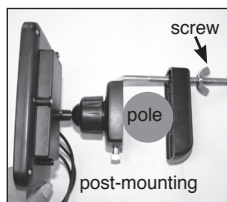

post-mounting

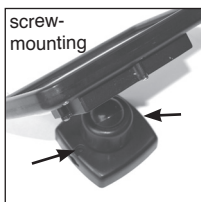

screw-mounting

4. Now, connect the 4 plugs of the spotlight and movement sensitive with the sockets on the rear from the solar module.

**Note:** Those are humidity-protected plugs. Put the plugs together completely. The plug of the movement-sensitive switch differs from the plugs of the spotlights.

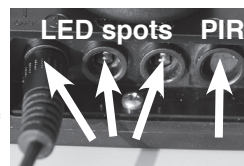

5. Now set the switch on the back side of the solar module to the position "ON". The solar spotlights are now activated.

**Note:** During the winter months the duration of illumination will generally be shorter. If the lamp should not shine on the first evening, please wait for a sunny day.

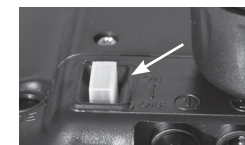

## 5. Exchange of Accumulators

After one to two years, the capacity of the accumulator pack will decrease. It is then required to exchange the accumulators. The accumulators are available in the shops or from the manufacturer.

1. Unscrew the 4 screws on the back side of the solar module and take off the cover.
2. Take the accumulator from the mounting bracket
3. Insert the new accumulator with correct polarity and close the housing in reverse order.

**Note:** Use batteries or accumulators must be disposed of in a non-polluting way and do not belong into the domestic waste. Your dealer is legally obliged to take back the old accumulators.



## 6. Malfunctions

- **Lamp is not automatically switched on at darkness**
- An outside light source (e.g. streetlight) simulates daylight and prevents the lamp from switching on. Place the lamp at a darker location.
- **Lamp is not switched on at darkness or only for a short period of time.**
- Is the lamp connected?
- Accumulator weak or defective. Exchange of the accumulators.

## 7. Specifications

Power Solarmodule:	1 Wp
Detection range motion detector:	90°/ 6m
Switching time:	30 sec.
Protection class:	IP 44
Battery:	3 pcs. NiMh 1.2 V/ 900 mAh AA-size
Illuminating units:	3 cold white „Nichia“ LEDs
Illumination time:	max. 8 h with a full battery
Light color:	6000 K
Luminous flux:	13 lm each spotlight

### Battery take-back

- Batteries must not be discarded into domestic waste.
- The consumer is legally required to return batteries after use, e.g. to public collecting centers or to battery distributors.
- Contaminant-containing batteries are labeled with the sign "crossed-out trashcan" and one of the chemical symbols. Used batteries should be disposed environmentally friendly and should not be discarded into domestic waste. Your dealer is legally required to take back old batteries.



### Rechargeable battery notes

- Rechargeable batteries should not be played with by children. Never leave rechargeable batteries lying around; they could be swallowed by children or pets.
- Rechargeable batteries must never be short-circuited, disassembled or thrown into fire. This leads to a danger of explosion!
- Leaking or damaged rechargeable batteries can cause chemical burns when they come into contact with skin. For this reason, please make use of suitable protective gloves.
- Rechargeable batteries should only be replaced by structurally identical rechargeable batteries from the same manufacturer. Normal batteries must not be used since these are not rechargeable.
- Make sure the rechargeable batteries are inserted with the correct polarity.
- For long periods of time of non-use (for example, storage), remove the inserted rechargeable batteries to avoid damages via the leaking rechargeable batteries.

### Manufacturer/Importer/Spare parts:

esotec GmbH - Gewerbegebiet Weberschlag 9 - D-92729 Weiherhammer  
Tel.-Nr: +49 9605-92206-0 Fax.-Nr: +49 9605-92206-10  
e-mail: info@esotec.de Internet: www.esotec.de  
**Product Art.-Nr: 102144**

### Disposal:

Dear customer,  
please cooperate in avoiding waste. When you intend to dispose of the product in future, please consider that it contains valuable raw materials suited for recycling.

Therefore, do not dispose of it with domestic waste but bring it to a collection point for the recycling of waste electrical and electronic equipment.

Thank you very much for your cooperation!

Copyright, esotec GmbH

