

Operating instructions

Solar Flamelight „Jasmin“



Customer support:

If you have problems or questions regarding this product, simply contact us!

By phone: +49 9605-92206-0

By e-mail for ordering spare parts: ersatzteil@esotec.de

By e-mail for questions about the product: technik@esotec.de

Product: Manufacturer Item No.: 102099

These instructions relate **ONLY** to this product and contain important information for using the product for the first time. Please keep these instructions for later reference and should always accompany the product in the event of transference to a new user.

1. Introduction

Dear Customer,

Thank you for purchasing the solar light.

With this solar light you purchased a product manufactured according to the current state of technology.



This product fulfils all requirements of the valid European and national regulations. The conformity was proved. The relevant declarations and documentation are deposited with the manufacturer.

To maintain this state and guarantee a safe operation, you as the user will have to follow this operating manual!

2. Safety Instructions



- In case of damages caused by not following this operating manual, the warranty rights will expire! We exclude liability for any consequential damages!
- We exclude liability for property or personal damages caused by inappropriate handling or not following the safety instructions.
- In these cases any guarantee rights will expire.

Due to safety and admission reasons (CE) it is not allowed to arbitrarily reconstruct and/or change the solar light.

Therefore, please keep to the operating manual. The accident prevention rules of the association of the industrial trade cooperative association for electric plants and working material are to be considered in industrial environments

3. Intended Use and Function

The solar light is designed for outdoor use. It must be placed in a shade-free sunny position. Normal rain cannot damage the lamp. During the winter months, the luminaire must be switched off and charged before wintering indoors.

ATTENTION: It is essential to ensure that the solar lamp is in a firm position due to the glass body. Please also take into account any winds that may occur. If the glass breaks, there is a risk of injury!

The built-in battery is charged by the solar cell inside the lamp. The light switches on automatically at dusk and switches off again at dawn. The light source is 36 yellow/orange LEDs. These are controlled by electronics and simulate a realistic flickering candle.

During longer periods without sunlight, the battery is insufficiently charged to ensure that it is always ready for operation. However, this does not mean that the solar lamp is defective. Wait for the next sunny days and the light will work again or charge the battery in a standard charger.

4. Putting into Operation

1. Carefully remove the lamp from its packaging.
2. Slide the switch on the bottom of the lamp to the "ON" position (Fig. 1).

The solar light is now activated and ready for use!



5. Exchange of the rechargeable battery

With solar lights, the battery must be replaced every 2 years on average. Please only insert an identical battery with the same voltage and capacity. If you do not find this capacity on the market, you can also use batteries with a higher capacity.

1. Slide the switch on the bottom of the lamp to the "OFF" position.
2. Use a suitable screwdriver to remove the 6 screws on the battery compartment on the underside of the lamp, remove the cover (Fig. 2) and remove the plastic seal.
3. Remove the battery from the holder and replace it with a new, freshly charged battery of the same size (Fig. 3).
4. Replace the seal in the battery compartment and press the cover back on. Replace the 6 screws with a suitable screwdriver.
5. Slide the switch on the underside to the "ON" position

Note: used batteries must be disposed of in an environmentally friendly manner and should not be placed in your household waste. Your dealer is obliged by law to take back the old rechargeable batteries.

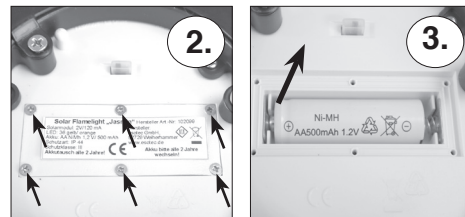

6. Malfunctions

- **Lamp is not automatically switched on at darkness**
- An outside light source (e.g. streetlight) simulates daylight and prevents the lamp from switching on? Place the lamp at a darker location!
- **Lamp is not switched on at darkness or only for a short period of time.**
- Is the lamp connected?
- Accumulator weak or defective? Exchange of the accumulators.

7. Technical Data

- Solar module: crystalline 2 V/ 120 mA
- Illuminant: 36 yellow/ orange LEDs
- Battery: 1 x NiMh 1.2 V/500 mAh (AA)
- Protection class: IP 44
- Type of protection: III
- Glow time: max. 6 h with a fully charged battery

Battery Recycling:

- Used batteries or accumulators must be disposed in the domestic waste.
- The consumer is legally obliged to bring back old accumulators upon usage, e.g. to public waste collecting locations or to the place (shops, etc.) where those batteries are sold.
- Batteries that contain harmful substances are marked with the "strike through dustbin" and one of the chemical symbols.

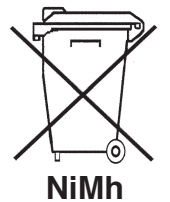

Rechargeable battery notes

- Rechargeable batteries should not be played with by children. Never leave rechargeable batteries lying around; they could be swallowed by children or pets.
- Rechargeable batteries must never be short-circuited, disassembled or thrown into fire. This leads to a danger of explosion!
- Leaking or damaged rechargeable batteries can cause chemical burns when they come into contact with skin. For this reason, please make use of suitable protective gloves.
- Rechargeable batteries should only be replaced by structurally identical rechargeable batteries from the same manufacturer. Normal batteries must not be used since these are not rechargeable.
- Make sure the rechargeable batteries are inserted with the correct polarity.
- For long periods of time of non-use (for example, storage), remove the inserted rechargeable batteries to avoid damages via the leaking rechargeable batteries.

Manufacturer/Importer:

esotec GmbH - Gewerbegebiet Weberschlag 9 - D-92729 Weiherhammer
Tel.-Nr: +49 9605-92206-0 - Fax.-Nr: +49 9605-92206-10 - Internet: www.esotec.de

Disposal:

Dear customer,

please cooperate in avoiding waste. When you intend to dispose of the product in future, please consider that it contains valuable raw materials suited for recycling.

Therefore, do not dispose it of with domestic waste but bring it to a collection point for the recycling of waste electrical and electronic equipment. Thank you very much for your cooperation!

